

REV  
NC **DT06-12S\***

REVISIONS			
SYM	DESCRIPTION	DATE	APPROVED
NC	REVISED AND REPLACES PREVIOUS		
	RELEASE PER E.O. P18204	6-27-03	RDR

DATE CODE: MONTH REPRESENTED BY SEQUENTIAL ALPHA CHARACTERS.  
EX. A = JANUARY

DATE CODE: YEAR IS REPRESENTED BY LAST NUMERICAL DIGIT.  
EX. 6 = 2006

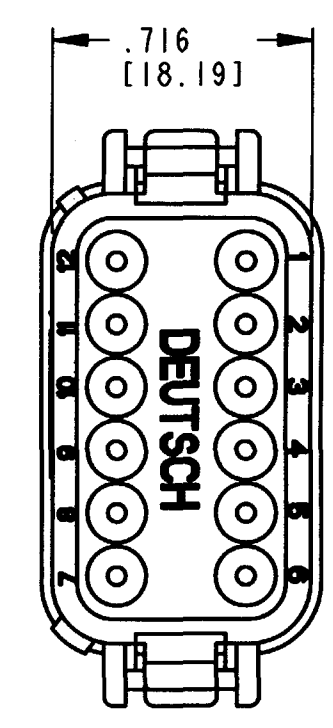
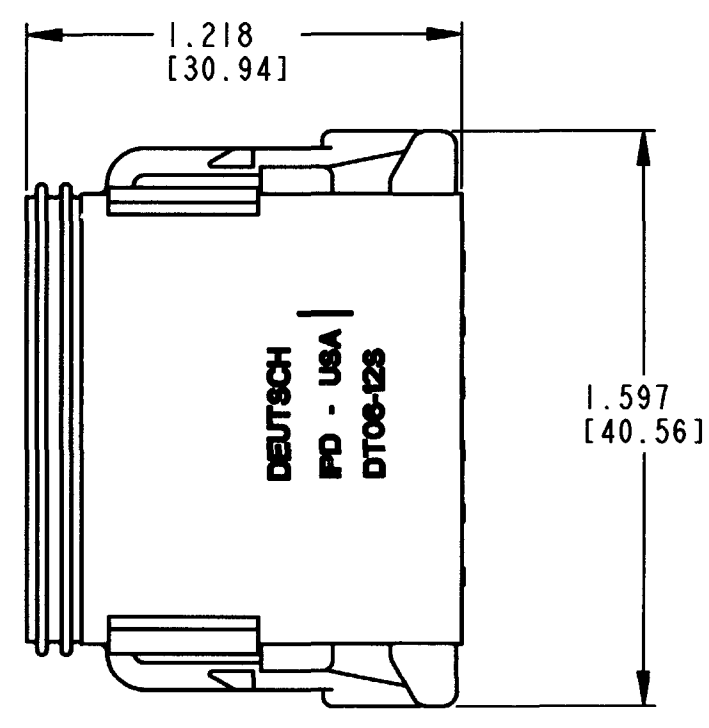
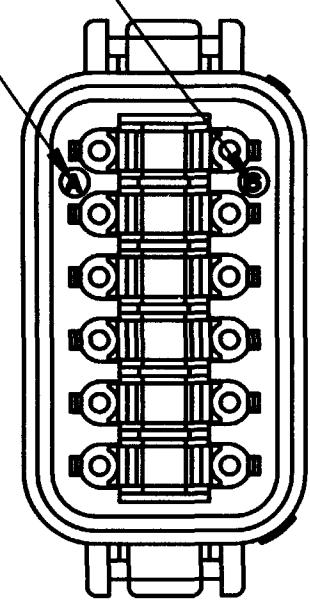

- 5. MATERIAL: SHELL: PLASTIC; GROMMET: RUBBER.
- 4. THIS PLUG MATES WITH DT04-12P\*-\*\*\*\* RECEPTACLE.  
(\* = A,B,C,D KEY ARRANGEMENT; \*\*\*\* = ALL MODIFICATIONS).  
CONSULT FACTORY FOR ALL MODIFICATIONS.

3. FOR CONTACTS AND WIRE PERFORMANCE AND APPLICATION CHARACTERISTICS,  
SEE ENVELOPE DRAWING 0425-015-0000 AND 0425-017-0000.

2. DIMENSIONS ARE ±.025[.64] UNLESS OTHERWISE SPECIFIED.

1. ALL DIMENSIONS ARE INCHES (MILLIMETERS).

NOTES:

CONTACT SIZE	MIN. INSUL O.D.	MAX. INSUL O.D.	WIRE RANGE [mm <sup>2</sup> ] REF. ONLY
16	.088 [2.24]	.145 [3.68]	14-20 AWG [2.0-0.5]

SIGNATURE & DATE	
DR	TYOHANNES 06JUN03
CHK	<i>[Signature]</i> 6/24/03
PE	<i>[Signature]</i> 6/20/02
APPD	<i>[Signature]</i> 6/23/03
SCALE	NONE WT

12 WAY PLUG  
DT SERIES

ENVELOPE

CP	MATL. CODE
<b>The Deutsch Company</b> DEUTSCH I.P.D. 3850 INDUSTRIAL AVE. HEMET, CALIF. 92545	
<b>B</b>	<b>DT06-12S*</b>
DWG SIZE 11139	SHEET 1 OF 2

REV	DT06-12S*	REVISIONS			
NC		SYM	DESCRIPTION	DATE	APPROVED
			SEE SHEET ONE	6-27-03	RDR

PART NO: DT06-12SA  
KEY ARR. -A-  
COLOR: GRAY

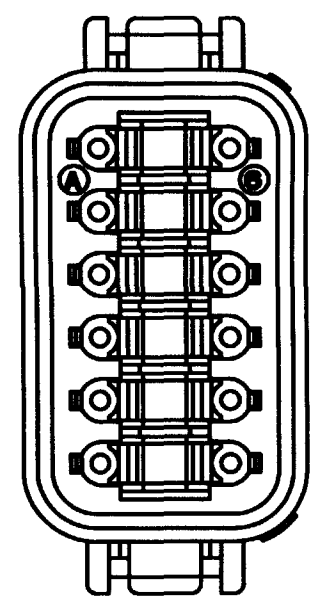

PART NO: DT06-12SB  
KEY ARR. -B-  
COLOR: BLACK

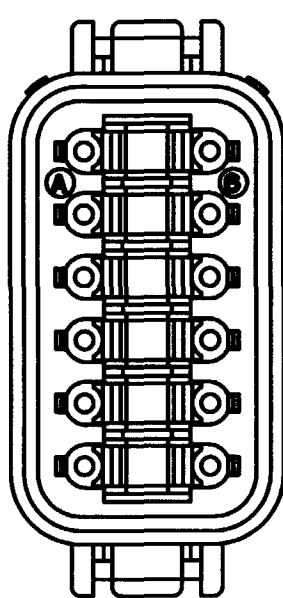

PART NO: DT06-12SC  
KEY ARR. -C-  
COLOR: GREEN

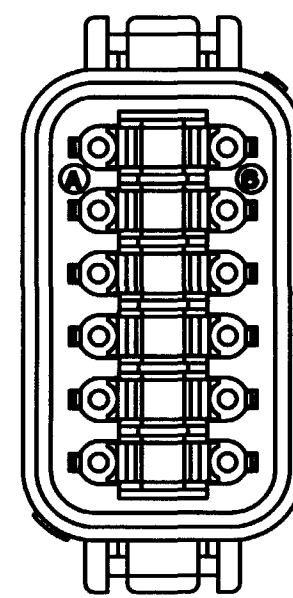

PART NO: DT06-12SD  
KEY ARR. -D-  
COLOR: BROWN

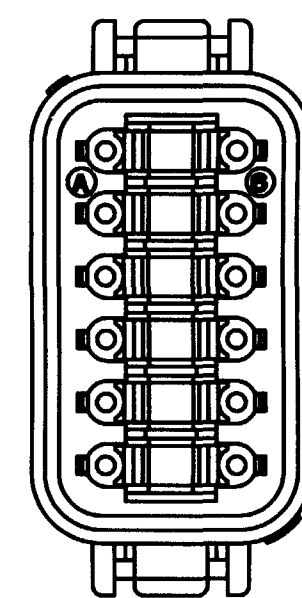

NOTES: SEE SHEET ONE.

SIGNATURE & DATE		12 WAY PLUG DT SERIES	CP	MATL. CODE
DR	TYOHANNES 06JUN03		The Deutch Company	
CHK	R. Kline 6/24/03		DEUTSCH I.P.D. 3850 INDUSTRIAL AVE. HEMET, CALIF. 92545	
PE	John Selam 6/20/03		DT06-12S*	
APPD	ESlund 6-23-03	ENVELOPE	B	DT06-12S*
SCALE	NONE WT		DWG SIZE	CODE 11139
				SHEET 2 OF 2